

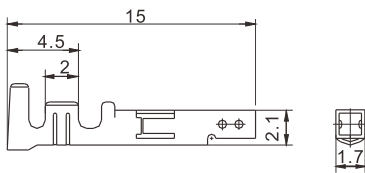

### 技术参数 ( SPECIFICATIONS )

适用线规 ( Applicable wires ) : AWG#28~AWG#22  
 适应基板厚度 ( Applicable PC board thickness ) : 1.6mm  
 温度范围 ( Temperature range ) : -20°C~85°C  
 额定电压 ( Voltage rating ) : 250V AC/DC  
 额定电流 ( Current rating ) : 5A  
 接触电阻 ( Contact resistance ) :  $\leq 0.02\Omega$   
 绝缘电阻 ( Insulation resistance ) :  $\geq 1000M\Omega$   
 耐压 ( Withstand voltage ) : 1500V AC/minute

### 端子 TERMINAL



型号 Type	适用导线范围 Wire Range		导线外径 Wire ins.Dis
	mm <sup>2</sup>	AWG#	
CH-TJC21	0.08~0.33	28~22	1.2~1.9
材质 · 表面处理 Material and Finish			
磷青铜 镀锡 Phos · bronze Tin · Plated			

### 阴连接器 HOUSING

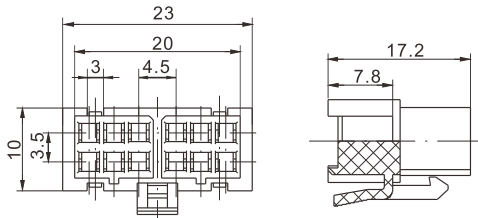

线数 Poles	型号 Type
12	TJC21-2x6Y
材质 · 表面处理 Material and Finish	
PA66 UL94V-0	

### 阳连接器 ( 弯式 ) HEADER ( 90° )

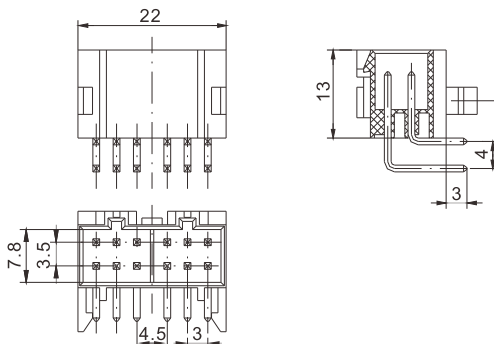

线数 Poles	型号 Type
12	TJC21-2x6AWJD
材质 · 表面处理 Material and Finish	
PA66 UL94V-0; 黄铜 镀锡 Brass Tin · Plated	

### 安装尺寸 MOUNTING MEASUREMENT

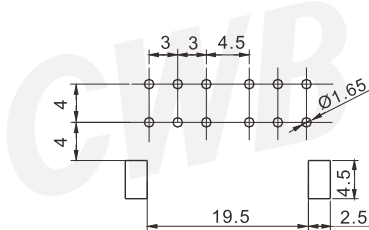

PCB Layout

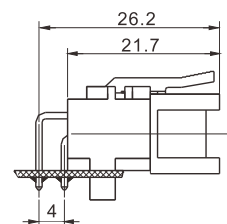

Assembly View (DIM FYI)